

A Prototype of an Artificial Life Generative Agent

BETSY BARNARD

North Carolina State University

INTRODUCTION

Architects and designers today use computers to perform a myriad of tasks: everything from construction drawings to analysis of energy efficiency; from sizing columns and beams to generating presentations for clients. In fact, a great many of the tasks that were previously performed manually are now performed with a computer.

While automating these tasks has (arguably) given us faster, more complex, more accurate and economical results, the impact on the process of architectural design has been minimal. The computer has not made a difference in the *kinds* of tasks the architect performs. The computer is used as a production tool; a means of effecting a result; or as *an investigative agent*, a way of testing ideas and generating new ones. Investigative agents engage the designer in a dialogue and give information back. Each type of investigative agent gives back a unique kind of information. Thus, computers have joined the ranks of the pencil and the model in our arsenal of design tools.

While the computer has found wide-spread use as a tool of production, its use as an investigative agent has found fewer converts. Perhaps it is because sketches and models already serve us quite well; they are inexpensive, quick, portable, and still function if the electricity goes off. However, the fact that many people have invested substantial amounts of money in computer systems should give us impetus to search for more uses for these systems (if curiosity is not incentive enough). *Are there ways the computer can assist us that are unique to the computer, unable to be duplicated by any other means? Can we get more uses out of the technology we have now, without waiting for and investing in artificial intelligence and virtual reality?*

This project began as a three-month exploration of the concepts of Artificial Life, genotype/phenotype, emergent form, and evolution applied to architecture. In exploring these concepts, ideas about a human/computer partnership were developed and the prototype for a new kind of computer agent was created.

ARTIFICIAL LIFE

Artificial Life is the study of man-made systems that exhibit behaviors characteristic of natural living systems (Langton, 1987).

Living systems consist of many components, each acting and interacting according to a set of behaviors. Each individual in the system interacts locally with its immediate neighbors in response to local conditions. Taken together, the local individual actions and interactions form a system that exhibits complex, dynamic behavior. There is no one overriding program that directs the behavior of a natural system. The global behavior emerges from the myriad of local interactions among individuals.

This is also the way a man-made Artificial Life system works. A group of simple elements, each acting according to a simple set of rules and interacting only with its immediate environment, can exhibit emergent, complex, dynamic behavior.

The principles of Artificial Life can be applied not only to emergent behavior, but also emergent form. The relationship between an emergent form and its generating rules is essentially a genotype/phenotype relationship. The rules contained in the genotype are applied recursively to the elemental building blocks until a complex phenotype emerges. Evolution is the process through which the genotype is refined to produce optimum form and behavior for a given environment.

THE PROJECT

The rules that I chose to apply were originally developed by the mathematician John Conway in the late 1960's (Garnder, 1990). Conway was (and is) a connoisseur of games, and especially of cellular games. A cellular game is played with a grid of cells, each cell taking on certain values depending on the rules of the game.

John Conway called his game "Life." Life is played on a grid of squares ("cells"), each of which could have two possible values: occupied or unoccupied. Conway called the

occupied squares "alive" and the unoccupied squares "dead." The rules he developed were applied to each cell on the grid in turn. After the rules had been applied to all of the cells, the grid was updated to reflect the new values of the cells. The rules are then applied to each cell again. Each application of the rules is considered one generation.

In this project, a series of Pascal programs were written that applied a simple rule structure to a simple set of building elements: a column, a beam and a wall. A slightly modified version of the Life rules is used by the program, which displays each generation in a 2-D (plan) view. Interesting configurations can be imported into Alias UpFront and displayed as a 3-D surface model.

Rules for Columns:

Initial Cell Value	Number of Neighboring Columns	Cell Value in Next Generation
Empty	1 or fewer	Empty
Short Column	1 or fewer	Empty
Tall Column	1 or fewer	Short Column
Empty	2	Empty
Short Column	2	Short Column
Tall Column	2	Tall Column
Empty	3	Short Column
Short Column	3	Short Column
Tall Column	3	Tall Column
Empty	4 or more	Empty
Short Column	4 or more	Tall Column
Tall Column	4 or more	Short Column

Rules for horizontal elements (walls and beams):

Target Cell Value	Contents of Cell Right of Target	Contents of Cell Below Target	Inserted
Short Column	Short or Tall Column		Wall
Short Column		Short or Tall Column	Beam
Tall Column	Tall Column		Wall
Tall Column		Tall Column	Beam

RESULTS

By the repeated application of the rules, organized structures emerge. Different morphologies can be created by changing the initial data file (which represents an initial configuration of columns). An unexpected result is that if the original data file is symmetrical, the resulting morphologies will be symmetrical.

A NEW TYPE OF AGENT

Investigative agents are used as part of a dialogue, where the designer must first ask the question, then investigate answers through the use of the agent. With the Artificial Life agent, however, *the agent does not wait for the designer to ask the question*. By using this type of agent, we are using the computer as more than investigative agent as a *generative agent*, which proactively gives information to the designer. A generative agent is a new type of agent, one that has been made possible only by the advent of the computer. We have

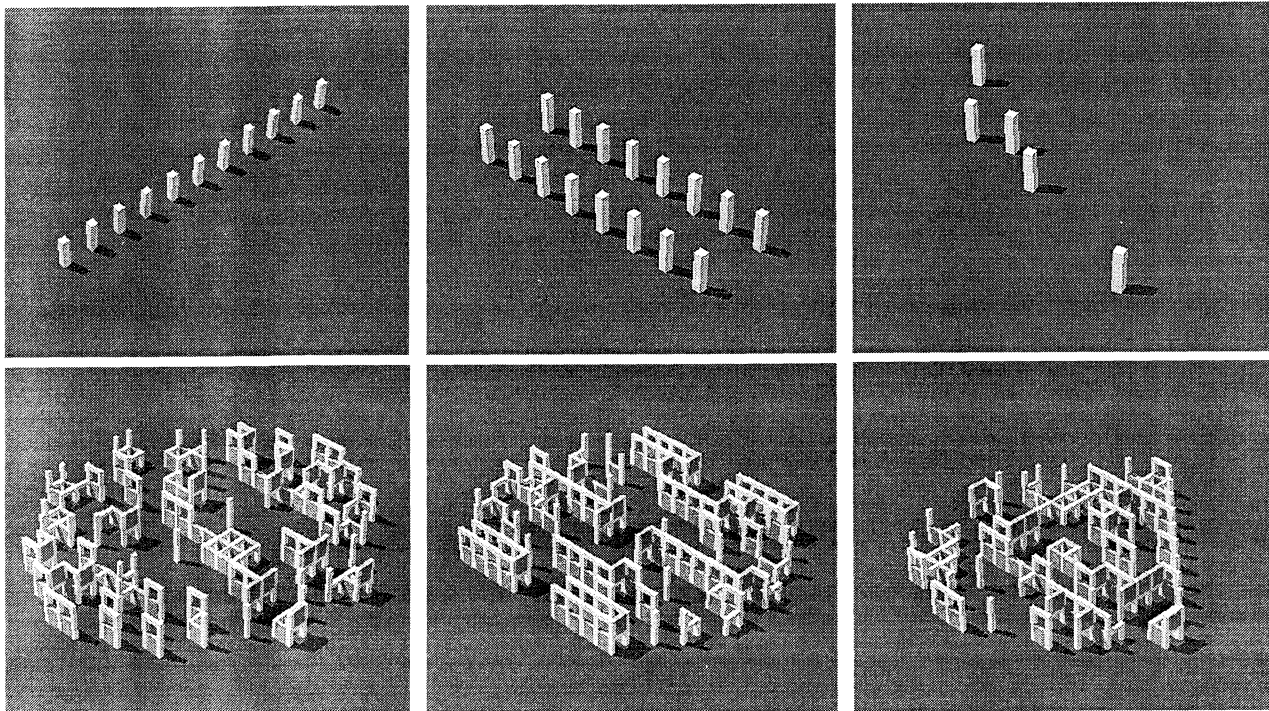

Fig. 1. The top row of pictures displays three different starting configurations. The result of each starting configuration after 12 generations is shown in the second row. When the initial configuration is symmetrical, each subsequent generation is also symmetrical.

no other means of obtaining this type of information.

Using the concepts of Artificial Life in the form of a generative agent has several benefits:

It uses existing hardware and inexpensive software (total development costs for a Pascal compiler and a copy of Alias UpFront: under \$200).

What the computer is doing is simple, transparent and understandable by inexperienced computer users, who may be unsure of just how much "thinking" their computer is doing.

The Artificial Life agent does not try to replace the human designer with a computer program. A human designer possesses attributes such as intuition, experience and cultural values that cannot be duplicated by a computer now or in the foreseeable future. The emphasis is not on duplication of human talents, but on the unique attributes inherent in the computer, and how these can be best used to complement the attributes possessed by the human designer.

The computer is uniquely suited to generation, organization and presentation of data, while the human is uniquely suited to understanding relationships and patterns in that data. This is what the Artificial Life agent does, tirelessly generating and presenting data. Once the data has been organized and displayed by the computer, the designer can begin the process of making sense out of what is displayed. However, as with other agents, the designer should not be a passive interpreter. The designer can influence what sorts of morphologies are generated by changing the initial data file, changing the rules, the structural elements or the configuration of the grid.

The results are free from the preconceived ideas of the designer. One cannot tell by looking at a table of the rules what emergent morphologies will be generated by those rules. Each generation brings something new and surprising.

Perhaps most importantly, working with this agent is fun.

Watching the computer generate the structures is fascinating, and has the aura of a game. Working with the results in UpFront is easy, fostering an attitude of play.

A generative agent may also suggest changes to the design process. The Artificial Life generative agent is not amenable to top-down, functional decomposition types of design. It suggests a design process that is instead bottom-up, beginning with elementary components, and letting the computer make suggestions about how those components could go together to produce an organized morphology. The design concept does not have to come from elsewhere, but could be suggested by the generative agent. The designer watches and interprets the results, looking for emergent morphologies that suggest an interpretation, or multiple interpretations.

The agent generates suggestions so rapidly that many concepts could be explored. The designer would have the luxury to discard concepts that are not promising, without worrying that another idea may not be forthcoming.

FUTURE PLANS

Future plans call for the development of an interface that would turn this prototype into a full-fledged generative agent. Its uses could then be more fully explored by myself and others. The ultimate goal is to explore evolution of structures by making it possible for users to combine sets of rules. By selective combination of rules that achieve desired morphologies, it should be possible for the designer to practice a sort of genetic engineering, breeding structures with desired characteristics. It may be possible to "evolve" two or more systems to work together i.e., a structural system that evolved in response to the characteristics of a mechanical system or vice versa.

It would also be interesting to explore the effect of using different elementary components. Currently, the computer

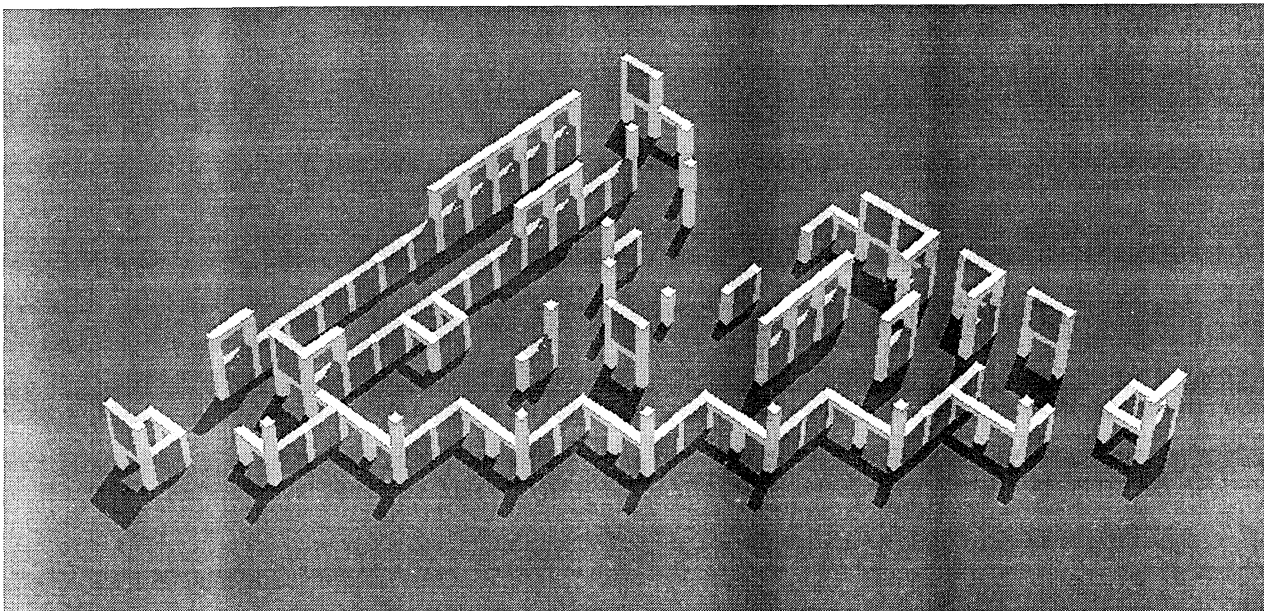

Figure 2. Beginning with three columns in a corner of the 30-by-30 grid, the above morphology emerged after seven generations.

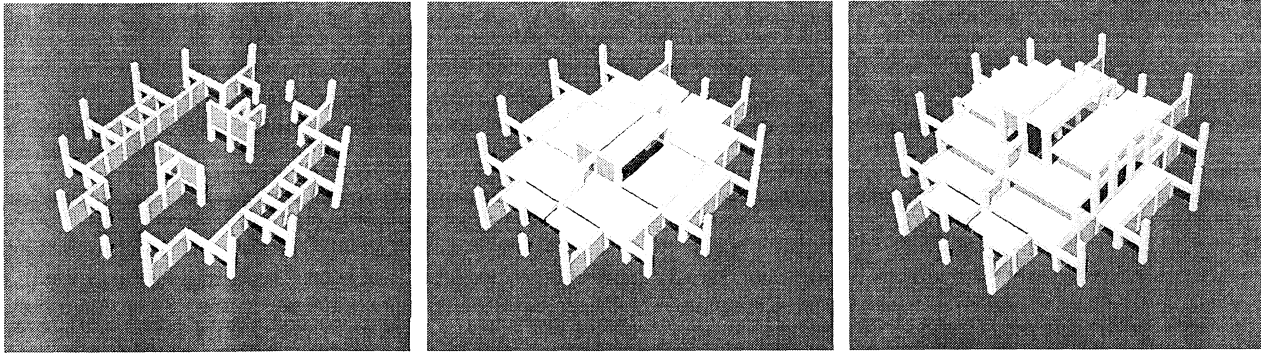

Figure 3. The designer takes an interesting morphology (left), and sees in it an intriguing idea of pieces being “slid out” from the center. The designer next chooses to add horizontal planes as “roofs” (center), and from there continues to expand upon the suggestion originally given by the computer (right). The whole series took five minutes to generate.

generates suggestions at a fairly abstract level, due to the abstract nature of the column, beam and wall. This level of abstraction invites quite a bit of interpretation from the human designer. Other levels of abstraction might suggest ways in which this generative agent could be used at different phases of the design process.

We have on our desktops now more computing power than could be imagined a decade ago. I believe that generative agents will be a key to more fully utilizing this power. As we search for and develop such agents, we may begin to see the fulfillment of the dream of a true partnership between humans and computers.

ACKNOWLEDGEMENTS

I am grateful to the following people who made this project possible:

John Tector of the North Carolina State University School of Design, who encouraged me in this project and gave me considerable help with the programming.

Lee Anderson of the University of Minnesota, who provided information and assistance with UpFront.

Sharon Roe of the North Carolina State University School of Design, who introduced me to the concept of Artificial Life, and who generously shared many of her ideas with me.

REFERENCES

- Gardner, Martin. “Mathematical Games: The Fantastic Combinations of John Conway’s New Solitary Game ‘Life’.” *Scientific American*, October, 1990, 120-123.
- Langton, Christopher, ed. *Artificial Life - The Proceedings of an Interdisciplinary Workshop on the Synthesis and Simulation of Living Systems*. Redwood City, CA: Addison Wesley Publishing Co, 1987.

OTHER WORKS CONSULTED

- Dewdney, A.K. “Computer Recreations: The Game of Life Acquires Some Successors in Three Dimensions.” *Scientific American*, February, 1987, 16 - 24.
- Emmeche, Claus. *A Garden in the Machine: The Emerging Science of Artificial Life*. (translated by Steven Sampson). Princeton, NJ: Princeton University Press, 1994.
- Field, Michael and Martin Golubitsky. *Symmetry in Chaos: A Search for Pattern in Mathematics, Art and Nature*. New York: Oxford University Press, 1992.
- Sigmund, Karl. *Games of Life: Exploration of Ecology, Evolution and Behavior*. New York: Oxford University Press, 1993.